

Life More Secure.

The Door Switch is an over-the-door preventative measure for your psychiatric facility.

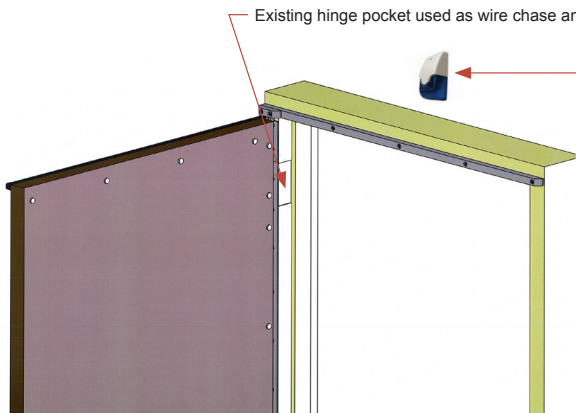

Beta Site Testing for Three Years... Retrofit Solution!

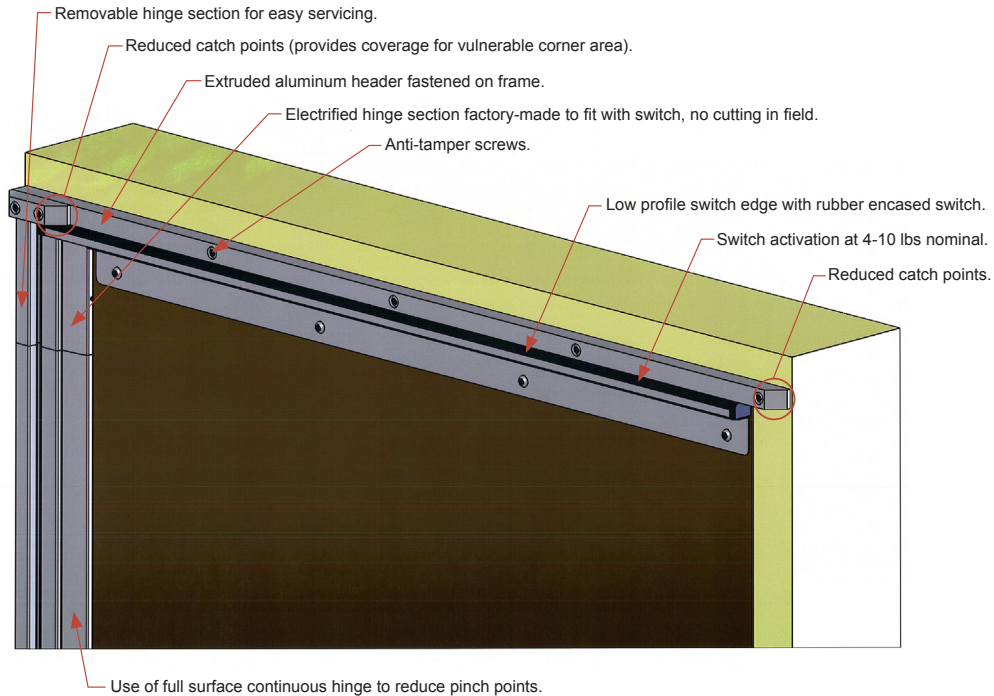

Key switch with high security Medeco core deactivates and resets the alarm (remote keypad also available).

Key reset of system at patient room assures patient safety.

BASIC MONITORING PANEL FEATURES

All wiring and alarm input/output devices are supervised to prevent tampering.

Contains a built-in addressable polling loop that accepts 120 alarm input/output points.

40 rooms available on single basic panel. Up to eight panels can be linked together to monitor a total of 320 rooms.

Keypad console audible indicator and two-line, 32 character LCD display alerts an alarm condition or system trouble at nurses' station.

Main panel provides an event log (history log) that can store up to 512 events. Logged events can be viewed on keypad console.

Keypad or laptop programmable.

Keypad "beep" walk test feature performed without triggering sirens and strobes.

Independently controlled notification devices (sirens) can be stationed in wings, floors and/or other designated areas of a facility.

Panel is UL, ULC, CSFM, FM, MEA.



Example of Basic Monitoring Keypad Console

The Door Switch is a patented design. (Patent No. 7,466,237)

For more information, please visit www.thedoorswitch.com or call toll free at (877) 998-5625.